

LEGEND:

WM	WATER METER	GV	GAS VALVE
LP	LIGHT POLE	MM	WATER METER
PP	POWER POLE	BL	BOLLARD
HC	HANDICAP PARKING	AG	ANCHOR GUY
P.O.B.	POINT OF BEGINNING	TP	TELEPHONE PEDESTAL
R.O.M.	RIGHT-OF-WAY	EMH	ELECTRICAL MAWHOLE
EM	ELECTRIC METER	CB	CABLE BOX
SMH	SEWER MAWHOLE	OCM	OLD CHISEL MARK
INLET	DRAIN INLET	IP	IRON PIN
DMH	DRAIN MAWHOLE	OE	OVERHEAD ELECTRIC
GM	GAS METER	FH	FIRE HYDRANT

- GENERAL NOTES:**
- SUBJECT PROPERTY IS LOCATED IN ZONE "X" PER FIRM MAP PANEL 1-38503 (PORTLAND, OREGON). "X" IS AN AREA DETERMINED TO BE OUTSIDE 100 AND 500 YEAR FLOOD PLAIN PER FIRM MAPS.
 - THERE ARE NO VISIBLE ENCROACHMENTS ON THIS PROPERTY.
 - GHASSEMI & ASSOCIATES DID NOT DO TITLE SEARCH AND IS NOT RESPONSIBLE FOR ACCURACY OF TITLE WORK.
 - CONTOURS BASED ON AN ASSUMED ELEVATION OF 100.00 FOR A P.K. NAIL SET IN THE SOUTH SIDE OF OLD JOE ROAD.

LEGAL DESCRIPTION

Beginning at a point on the East line of Old Joe Road (50' Right-of-Way), said point being the Southwest corner of Lot 18, County Home Estates, 2nd Addition, Section 3, Township 3 South, Range 8 West, as recorded in Plat Book 52, Page 9, in the Chancery Court, Hernando, Desoto County, Mississippi; Thence, along the South line of said Lot 18, South 89°41'56"E, a distance of 527.13 (call = 527.13) feet to a found iron pin, Thence, South 00°11'50"E, a distance of 226.21 (call = 226.23) feet to a found iron pin, said point being the Northeast corner of Lot 16 of said subdivision; Thence, along the North line of said Lot 17, North 89°37'28"W, a distance of 528.66 (call = 28.65) feet to a point on the East line of said Old Joe Road; Thence, along the East line of said Old Joe Road, North 00°11'18"E, a distance of 225.54 (call = 225.00) feet to a point, said point being the Point of Beginning of said Parcel containing 119,239 square feet or 2.7374 acres more or less of land.

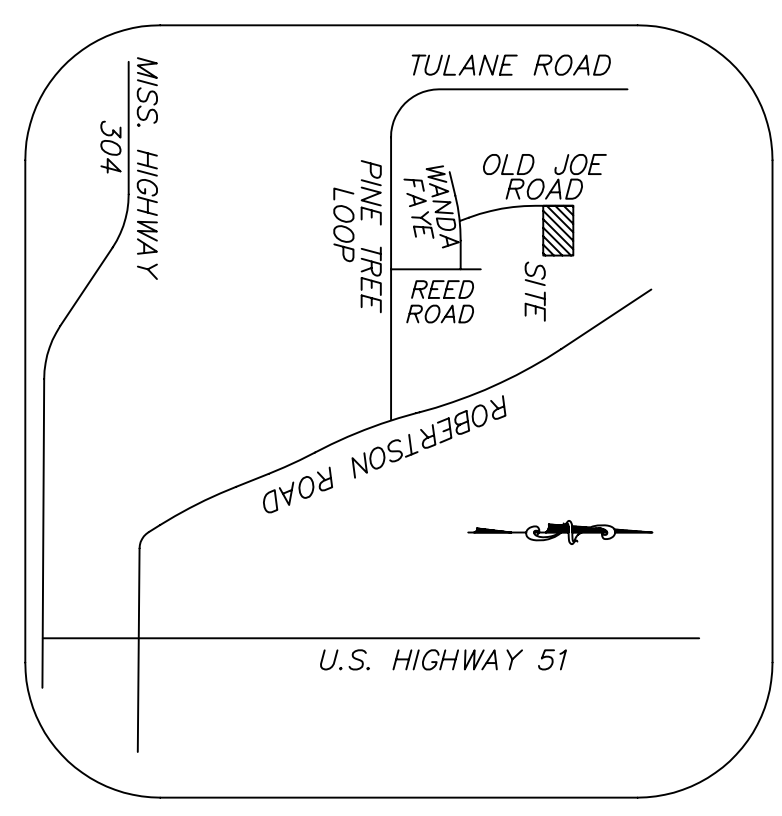
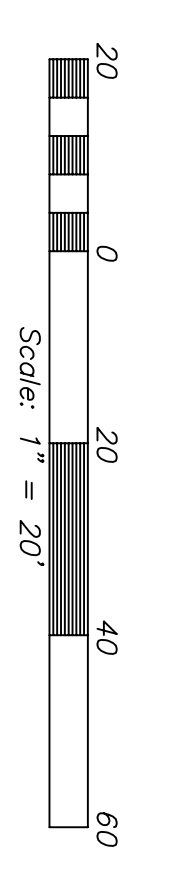

BOUNDARY & TOPOGRAPHIC SURVEY OF

LOT 17 - COUNTY HOME ESTATES, 2nd ADDITION
SECTION 3, TOWNSHIP 3 SOUTH, RANGE 8 WEST
AS RECORDED IN PLAT BOOK 52, PAGE 9
HERNANDO, DESOTO COUNTY MISSISSIPPI

SCALE 1" = 20'
SURVEY DATE 11/13/2003

GHASSEMI & ASSOCIATES
ENGINEERS * PLANNERS * SURVEYORS
2904 HICKORY HILL ROAD
MEMPHIS, TENNESSEE 38115
(901) - 452 7100

M.R. GHASSEMI P.E., RLS
M.S. PLS# 02777

DATE _____

REVISIONS:

JOB NUMBER
0384286A

SHEET NUMBER
1 OF 1